





Blended expertise, purposefully applied...

We are a Chiswick based residential property consultancy that provides in-depth experience in the disciplines of estate agency, residential lettings, property management, property staging and interior design – a blend of expertise not commonly found in estate and lettings agency businesses.

Having this multi-faceted capability enables us to deliver success to our clients that are seeking a more bespoke and discreet experience than typically offered by high street estate or lettings agents.

Clients value our integrity, energy, expertise and unbiased advice...

The core values of our business are; integrity, clarity and success. Our advice and services are delivered from a trusted platform of professional qualification, experience, dedication and a wealth of in-depth knowledge. This thorough, yet innovative approach to everything that we do has resulted in a strong track record, as evidenced by consistent results and unquestionable success.

What is the new meaning of Bespoke?...

We work with an adaptable approach to our processes to suit individual clients requirements. For example; many of our clients want to avoid public promotion and seek discreet introductions. Over 70% of our transactions are completed without public marketing. We spend less time promoting ourselves and more time combining modern online marketing with a lifetime of networking to introduce the right person in the right way.

More doesn't mean more...

We consciously keep our active portfolio compact, so that we can successfully apply the time, high levels of detail, attention and management you require and deserve whilst achieving our joint objective, success.



SOUTHFIELD ROAD, W4

Welcome to this charming Edwardian garden maisonette, located on Southfield Road in the heart of Central Chiswick, W4. This delightful property boasts a spacious reception room, two cosy bedrooms, and a modern bathroom, offering a comfortable and inviting living space.

As you step into this newly decorated apartment, you'll be greeted by 685 sq ft of well-designed living space that perfectly blends classic Edwardian charm with modern convenience. The unfurnished property allows you the freedom to personalise the space to your taste, making it truly feel like home.

One of the highlights of this apartment is the private garden, providing a tranquil outdoor retreat right at your doorstep. Imagine enjoying your morning coffee or hosting a summer barbecue in this secluded oasis in the heart of the city.

Situated in a central location, you'll have easy access to a variety of amenities, including shops, restaurants, and green spaces. Whether you're looking to explore the local culture or simply run daily errands, everything you need is just a stone's throw away.

Don't miss the opportunity to make this charming Edwardian apartment with a private garden your new home. Contact us today to arrange a viewing and start envisioning your life in this wonderful property in Central Chiswick.





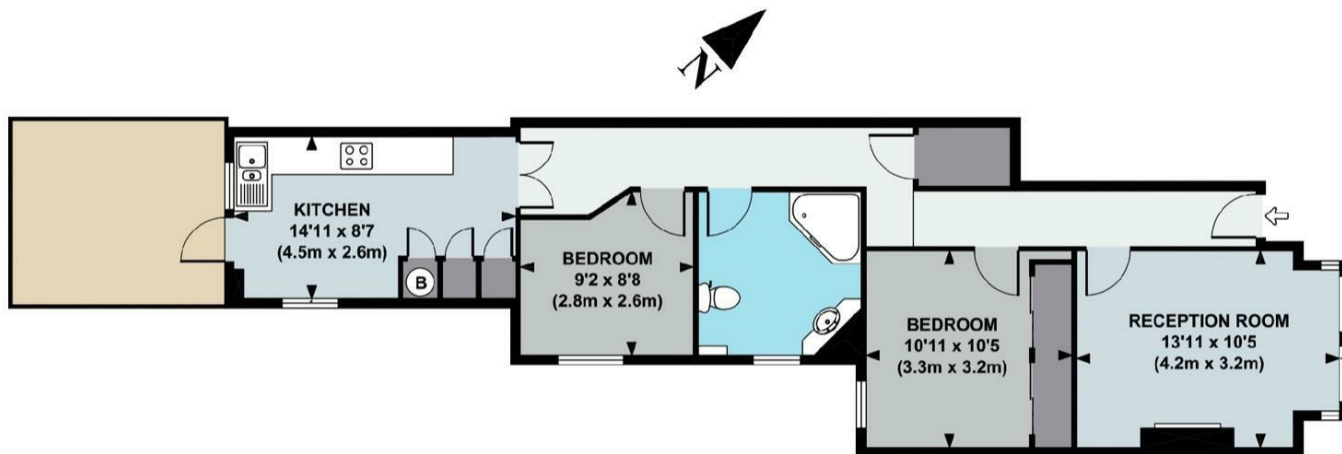

FIRST FLOOR

APPROX. GROSS INTERNAL FLOOR AREA 685 SQ. FT / 63 SQ. M

Floor plan produced in accordance with RICS Property Measurement Standards incorporating International Property Measurement Standards (IPMS2 Residential). © Red i 2021

Produced for illustration purposes and may not truly reflect design or dimensions and should not be used for valuation, condition or design purposes.

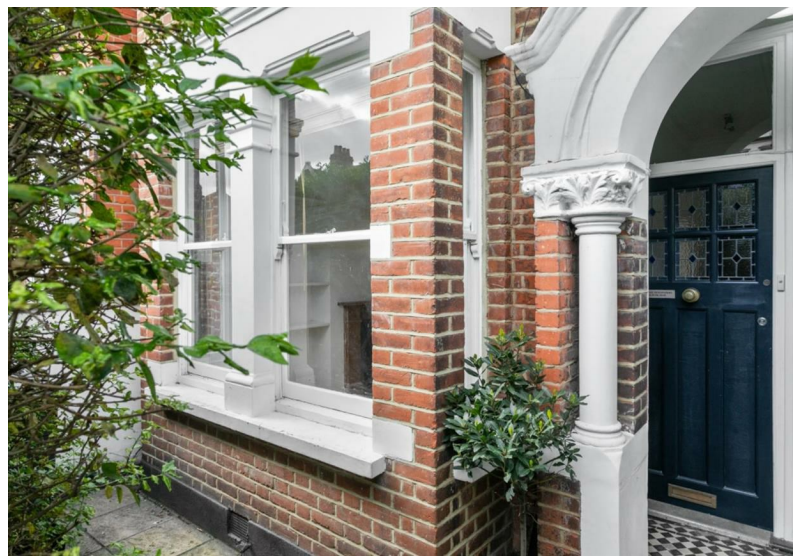

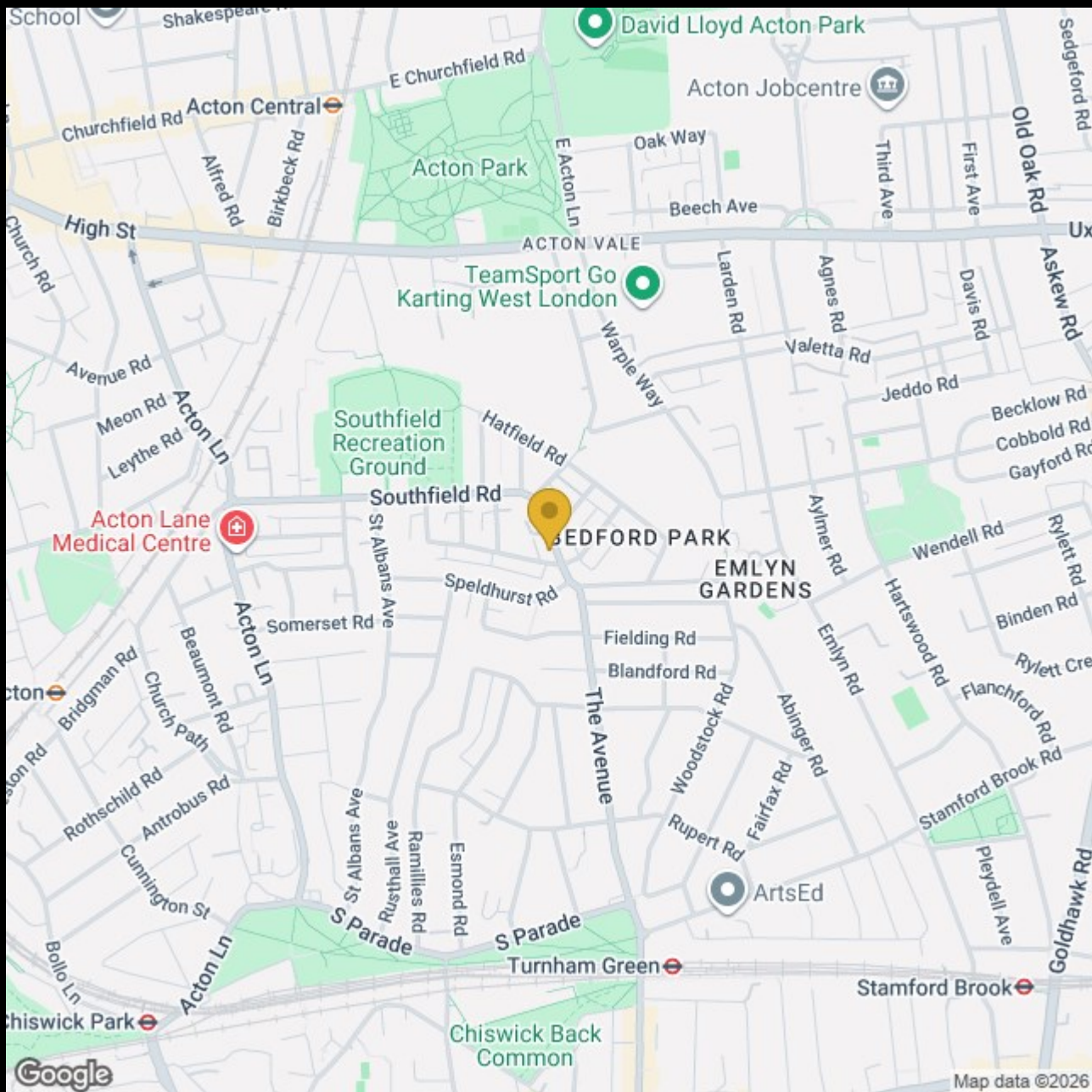

020 8995 2030
enquiries@harpersofchiswick.com
www.harpersofchiswick.com